

p/n: 00GSE-1039-02

Transfill Adapter, JIC4 x AN800 Nipple, 1 in

Date:

Cleaned for Oxygen Service per MH ESR-008



Aviation Oxygen Systems

**MOUNTAIN HIGH**  
Equipment & Supply Company

REV	ECO	Release	Drawn	REVISION HISTORY
-0	2021-009	2021-02-09	SGO	Customer Drawing

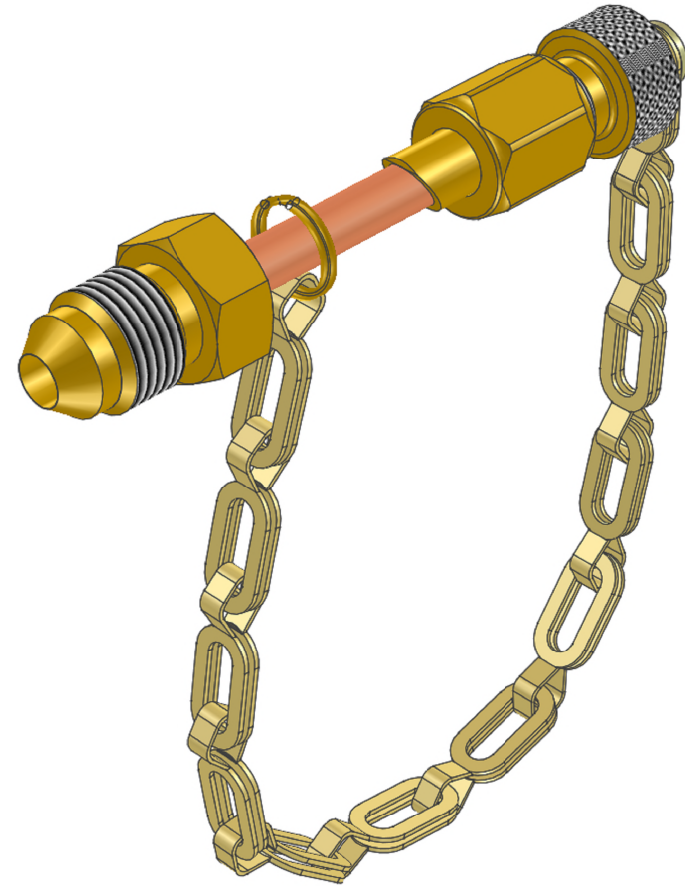
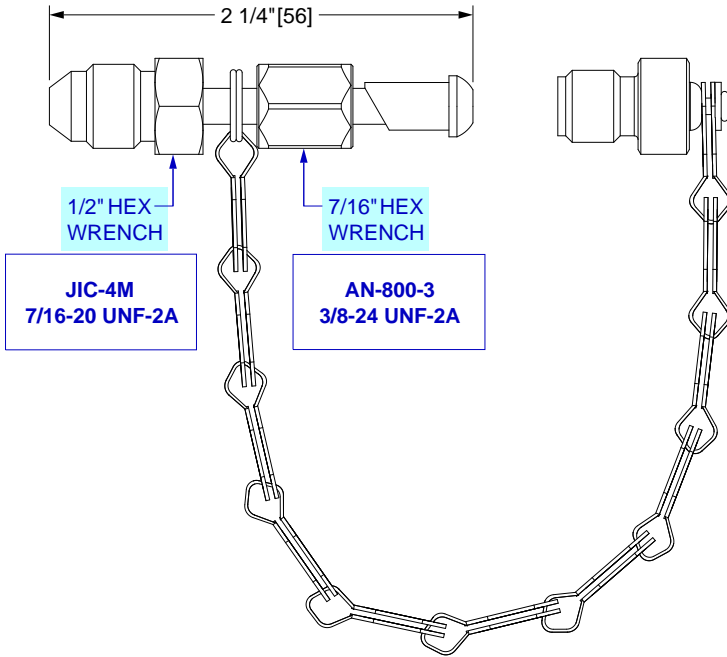

**GENERAL SPECIFICATIONS**

Material: UNS C36000 (CDA-360) Brass  
UNS C12200 (ASTM-B75) Copper Tubing

Assembly: Silver-Brazed, #56 Alloy

Weight: 1.4 oz [40 g]

Operating Pressure: 3000 PSI  
Temp Range: -50°F to +130°F [-45°C to +55°C]

Cleaned for Oxygen Service per MH ESR-008

UNLESS OTHERWISE SPECIFIED, DIMENSIONS ARE IN INCHES. DIMENSIONS IN [ ] ARE MILLIMETERS (REF)		<b>MOUNTAIN HIGH E&amp;S CO.</b> <b>REDMOND, OR. USA</b>	
TOLERANCES ARE: 0.X ±0.015 ANGLES ±3° 0.XX ±0.010 FRACTIONS ±1/64 0.XXX ±0.005			
INTERPRET GD&T PER ASME 14.5		THIS DOCUMENT AND ALL TECHNICAL DATA HEREON DISCLOSED ARE PROPERTY OF MOUNTAIN HIGH E&S CO. AND SHALL NOT BE USED, RELEASED OR DISCLOSED IN WHOLE OR PART WITHOUT WRITTEN PERMISSION FROM MOUNTAIN HIGH E&S CO. THIS DOCUMENT MUST BE RETURNED TO MOUNTAIN HIGH E&S CO. IMMEDIATELY UPON REQUEST.	
THIRD ANGLE PROJECTION 		<b>Customer Drawing, Transfill Adapter, JIC4 x AN800 Nipple, 1 in [SCD]</b>	
DWG TITLE <b>5SGSE-1039-02</b>		DWG NUMBER <b>5SGSE-1039-02</b>	
DWG NUMBER <b>5SGSE-1039-02</b>		DWG REV. <b>-0</b>	
SRC FILE 00GSE-1039-02\$-0		INV. PART NUMBER 00GSE-1039-02	
APPROVED HBS 2021-02-09		PROD. NAME TA-JIC4-AN800	
DO NOT SCALE DRAWING		DWG FORMAT: ESR-002 Rev H [26]	
DWG SCALE		DWG SHEET 1 OF 1	
DWG SIZE 11x8 1/2		DWG SIZE <b>A</b>	

Insert #: 5IGSE-1039-02