

p/n: 00GSE-1039-00

Transfill Adapter, JIC4 x AN800 Nipple, 3 in

Date:

Cleaned for Oxygen Service per MH ESR-008



Aviation Oxygen Systems
MOUNTAIN HIGH
Equipment & Supply Company

REV	ECO	Release	Drawn	REVISION HISTORY
B1	2022-007	2022-02-09	SGO	Customer Drawing

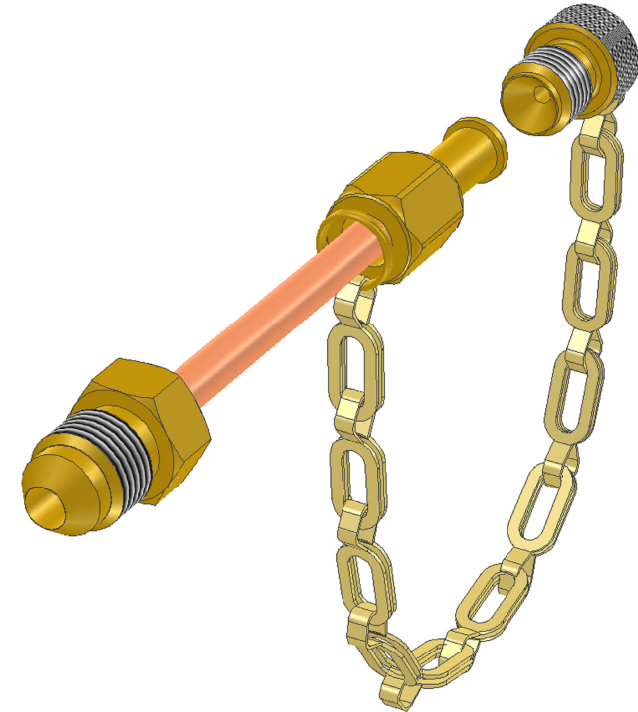
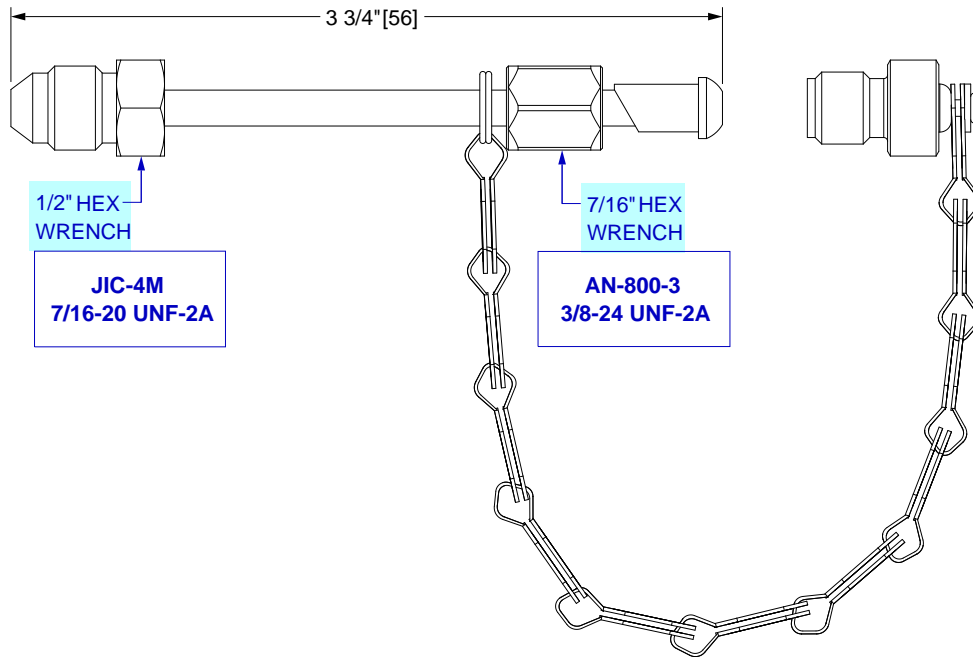

GENERAL SPECIFICATIONS

Material: UNS C36000 (CDA-360) Brass
UNS C12200 (ASTM-B75) Copper Tubing

Assembly: Silver-Brazed, #56 Alloy

Weight: 1.5 oz [43 g]

Operating Pressure: 3000 PSI
Temp Range: -50°F to +130°F [-45°C to +55°C]

Cleaned for Oxygen Service per MH ESR-008

UNLESS OTHERWISE SPECIFIED, DIMENSIONS ARE IN INCHES.
DIMENSIONS IN [] ARE MILLIMETERS (REF)
TOLERANCES ARE:
0.X ±0.015 ANGLES ±3°
0.XX ±0.010 FRACTIONS ±1/64
0.XXX ±0.005
INTERPRET GD&T PER ASME 14.5

THIRD ANGLE PROJECTION	DRAWN	SGO
	CHECKED	EAM
	ENGINEER	TD
	APPROVED	HBS
DO NOT SCALE DRAWING	2021-02-08	2021-02-09

MH MOUNTAIN HIGH E&S CO.
REDMOND, OR. USA

THIS DOCUMENT AND ALL TECHNICAL DATA HEREON DISCLOSED ARE PROPERTY OF MOUNTAIN HIGH E&S CO. AND SHALL NOT BE USED, RELEASED OR DISCLOSED IN WHOLE OR PART WITHOUT WRITTEN PERMISSION FROM MOUNTAIN HIGH E&S CO. THIS DOCUMENT MUST BE RETURNED TO MOUNTAIN HIGH E&S CO. IMMEDIATELY UPON REQUEST.

Customer Drawing, Transfill Adapter,
JIC4 x AN800 Nipple, 3 in [SCD]

DWG TITLE	5SGSE-1039-00		DWG REV.	B1
DWG NUMBER	SRC	INV. PART NUMBER	PROD. NAME	
	00GSE-1039-00	00GSE-1039-00	TA-JIC4-AN800	
DWG FORMAT:	DWG SCALE	DWG SHEET	1 OF 1	DWG SIZE
ESR-002 Rev H [26]				A 11x8 1/2

Insert #: 5IGSE-1039-00