

1

2

3

4

## REVISION HISTORY

REV	ECO NO. YYYY-MM-DD	NAME	NOTES
-	1996-04-27	PLM	INITIAL DRAFT
A	2009-01-28	PLM	CORRECTED TEXT ON SCALE AND PLACED ON NEW FORMAT
B	2024-045 2024-08-07	KQM	DRAWING WE-WORK & REVISIONS

A

B

C

D

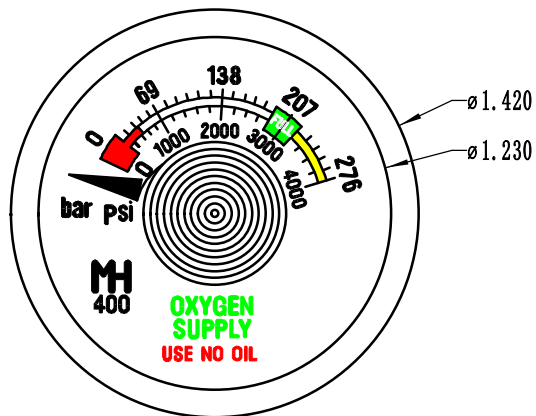

FRONT VIEW

Note: Gauge marked per MH  
in-house document: ESR-005

**SPECIFICATIONS:**

MATERIAL: BRASS, STAINLESS STEEL, & ACRYLIC  
 FINISH: NONE  
 MAX. PRESSURE: 276 BAR (4000 PSIG)  
 OPERATING RANGE: 207 BAR (0-3000 PSIG)  
 REAR AXIAL PORT: 1/8 NPT-M  
 TEMP RANGE: -25° F TO 225° F  
 TORQUE: 2-3 TFFT  
 RECOMMENDED TAPE: PTFE OXYGEN COMPATIBLE  
 ("A-A-58092" or MH p/n: 00VEN-0112-01)

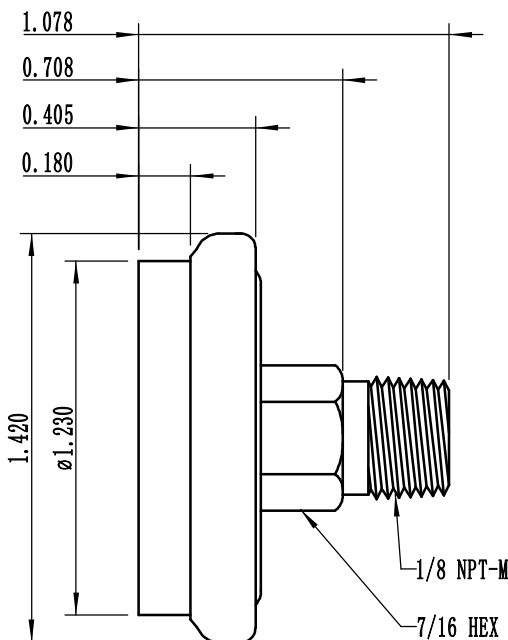

SIDE VIEW

**INSTALLATION NOTES:**

- Clean per MH in-house document: ESR-008
- Inspect gauge to ensure that male threads are free of nicks, burrs, dirt, ect. before wrapping with tape.
- Wrap threads with oxygen compatible tape 1-1/2 to 2 turns in a clockwise direction when viewed from end. Start at the 2nd thread from the end to avoid any tape debris contamination in the system.
- Screw the gauge into adapter fitting, ensuring threads are properly aligned. Torque to finger tight.
- Torque to final value with wrench, 2-3 turns from finger tight (TFFT)

A

B

C

D

UNLESS OTHERWISE SPECIFIED,  
DIMENSIONS ARE IN INCHES.  
DIMENSIONS IN [ ] ARE MILLIMETERS (REF)  
TOLERANCES ARE:  
0.X ±0.015 ANGLES ± 3°  
0.XX ±0.010 FRACTIONS ± 1/64  
0.XXX ±0.005  
63  
INTERPRET GD&T PER ASME 14.5

**MH****MOUNTAIN HIGH E&S CO.  
REDMOND, OR. USA**

THIS DOCUMENT AND ALL TECHNICAL DATA HEREON DISCLOSED ARE PROPERTY OF MOUNTAIN HIGH E&S CO. AND SHALL NOT BE USED, RELEASED OR DISCLOSED IN WHOLE OR PART WITHOUT WRITTEN PERMISSION FROM MOUNTAIN HIGH E&S CO. THIS DOCUMENT MUST BE RETURNED TO MOUNTAIN HIGH E&S CO. IMMEDIATELY UPON REQUEST.

THIRD ANGLE PROJECTION	DRAWN 2024-08-07	KQM	DOC TITLE MH-400 Pressure Gauge (SCD)
	CHECKED 2024-08-07	EAM	DOC NUMBER 5SCPG-1011-00
	ENGINEER 2024-08-07	JB	DWG REV. B
DO NOT SCALE DRAWING	APPROVED 2024-08-13	HBS	INV. PART NUMBER 00CPG-1011-00
			MODEL: 00CPG-1011-00
			DWG FORMAT: ESR-002 Rev H [27]
			DWG SCALE 1.5:1
			DWG SHEET 1 OF 1
			DWG SIZE 11x8 1/2

1

2

3

4