

1

2

3

4

REVISION HISTORY			
REV	ECO NO. YYYY-MM-DD	NAME	NOTES
-2	2024-044 2024-08-07	KQM	RE-RELEASE AS INSERT

INSTALLATION NOTES:

- Cut out gauge holes in Aircraft Panel (05) in desired location:
 - Center Gauge Face Hole: $\varnothing 1.375"$ (1-3/8") (35.26mm)
 - Fastener Holes (x4): $\varnothing 0.15"$ (3.85mm)
 - Use reference circle (as shown in Front View) for fastener hole spacing. ($\varnothing 2.121"$)
- Inspect Gauge (01) to ensure that male threads are free of nicks, burrs, dirt, ect. before wrapping with tape.
- Wrap threads with oxygen compatible tape 1-1/2 to 2 turns in a clockwise direction when viewed from end. Start at the 2nd thread from the end to avoid any tape debris contamination in the system.
- Screw the Gauge into NPT-TO-(XX) (CHOOSE ADAPTER AS REQUIRED) fitting (02), ensuring threads are properly aligned. Torque to finger tight.
- Torque to final value with wrench, 2-3 turns from finger tight (TFFT).
- Place o-ring (03) into Rear Mount Gauge Plate (04) as shown, then place Gauge into matching recess of Rear Mount Gauge Plate.
- Install Rear Mount Gauge Plate & Gauge Assembly (01-04) into the back of the Aircraft Panel (05) so that the face of the gauge protrudes through the $\varnothing 1.375"$ center hole & the threaded fastener holes on the Rear Mount Gauge Plate are aligned with the $\varnothing 0.15"$ fastener holes in the Aircraft Panel.
- Secure entire assembly to Aircraft Panel with (x4) 3/8" #6-32 UNC-2B Panhead Machine Screws (06) (09105-0606-00).

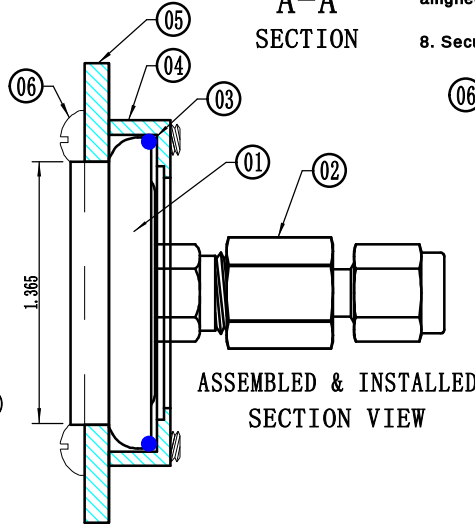
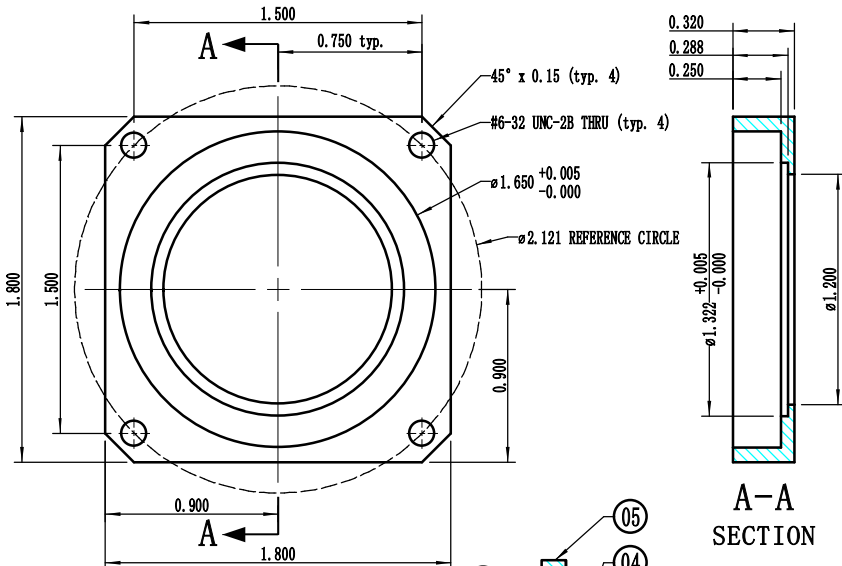

- ① MH-300 PRESSURE GAUGE, 0-3000PSI (00CPG-1010-00)
- ② 1/8 NPT-F to 1/8" O.D. TUBE ADAPTER FITTING (00HDW-0120-00)
- ③ O-RING, 2-029 S-050 (09001-1029-70)
- ④ REAR MOUNT GAUGE PLATE (00BLT-1076-00)
- ⑤ CUSTOMER AIRCRAFT PANEL
- ⑥ PANHEAD MACHINE SCREW, #6-32 UNC-2B (09105-0606-00)

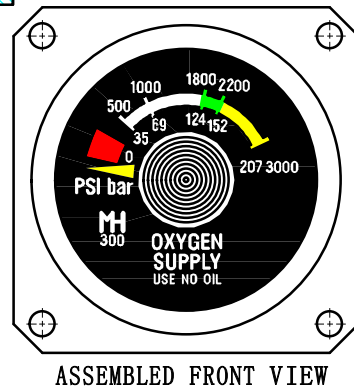
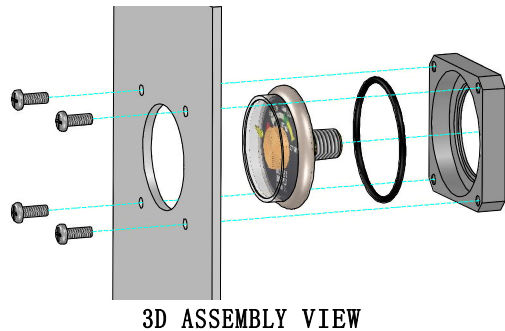

UNLESS OTHERWISE SPECIFIED,
DIMENSIONS ARE IN INCHES.
DIMENSIONS IN [] ARE MILLIMETERS (REF)
TOLERANCES ARE:
0.X ±0.015 ANGLES ±3°
0.XX ±0.010 FRACTIONS ±1/64
0.XXX ±0.005
63
INTERPRET GD&T PER ASME 14.5

MH MOUNTAIN HIGH E&S CO.
REDMOND, OR. USA
THIS DOCUMENT AND ALL TECHNICAL DATA HEREON DISCLOSED ARE PROPERTY OF MOUNTAIN HIGH E&S CO. AND SHALL NOT BE USED, RELEASED OR DISCLOSED IN WHOLE OR PART WITHOUT WRITTEN PERMISSION FROM MOUNTAIN HIGH E&S CO. THIS DOCUMENT MUST BE RETURNED TO MOUNTAIN HIGH E&S CO. IMMEDIATELY UPON REQUEST.

THIRD ANGLE PROJECTION	DRAWN 2024-08-06	KQM DOC TITLE Rear Mount Gauge Plate Drawing & MH-300 Panel Installation Insert
CHECKED 2024-08-07	EAM DOC/INSERT NUMBER 5ICPG-0030-00	REV. -2
ENGINEER 2024-08-07	JB SRCFILE 00CPG-0030-00\$-2	INV. PART NUMBER 00CPG-0030-00
DO NOT SCALE DRAWING	APPROVED 2024-08-13	HBS DWG FORMAT: ESR-002 Rev H [27] DWG SCALE: 1:1 SHEET #: 1 OF 1 DWG SIZE: A 11x8 1/2

1

2

3

INSERT #: 5ICPG-0030-00