

| REVISIONS (CAD CONTROLLED DO NOT MANUALLY REVISE) | | | | |
|---------------------------------------------------|--------|--------------------|----------|----------|
| LTR | DCN | DESCRIPTION | DATE | APPROVED |
| E | 6470BG | CHANGE PRIMER P/N. | 09-28-10 | TN |

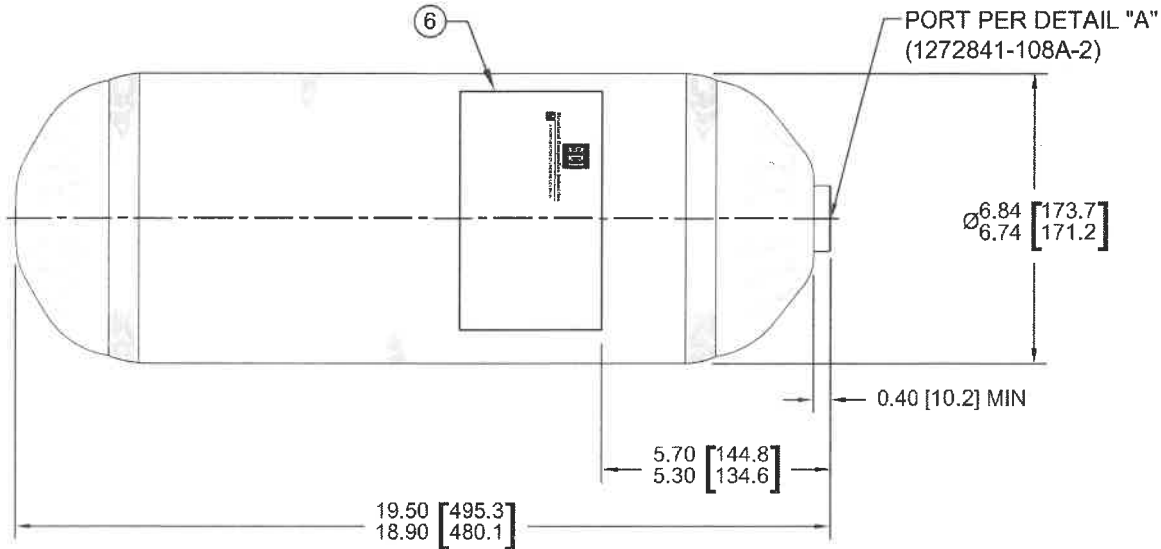
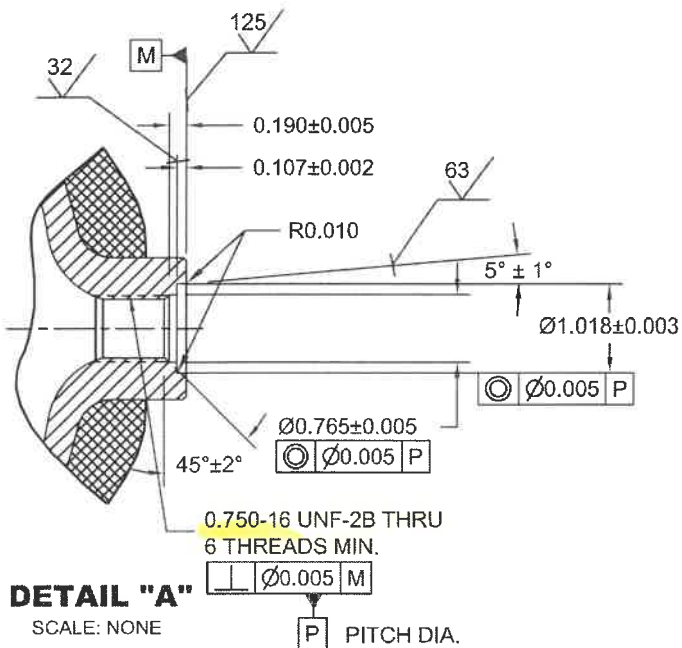

NOTES:

- FOR OXYGEN SERVICE, PRIOR TO FILLING THE CYLINDER SHALL MEET THE REQUIREMENTS FOR EXCESS HYDROCARBON PER RR-C-901.

| QTY REQD | U/M | JDE PART NO. | SCI DWG. NO. | DESCRIPTION | MATERIAL/SPECIFICATION | ITEM NO. |
|----------|-------|--------------|--------------|-------------------|------------------------------------|----------|
| 1 | EA | 313774 | 1271932-1 | LABEL - GENERIC | | 6 |
| AR | LB | 312736 | 1272056-1 | LABEL OVERWRAP | GLASS | 5 |
| AR | OZ | 312720 | 1270865-81 | COATING, EXTERIOR | UV COAT | 4 |
| AR | FL.OZ | 312708 | 1270865-61 | COATING, EXTERIOR | F. GREEN NO. 14187 PER FED-STD-595 | 3 |
| AR | FL.OZ | 312723 | 1270865-85 | PRIMER | FLAT BEIGE | 2 |
| 1 | EA | 313284 | 1271372-1 | CYLINDER, CURED | | 1 |

| | |
|----------------------------------------------|---------------------------------------------------------------------|
| CUSTOMER, P/N: N/A | QUAL./TEST REPORT: 97-2196 |
| STANDARD STRESS RUN: SSR602 | YIELD STRENGTH: 41,500 PSI |
| SPECIFICATION: TC-SU 5141/DOT-SP 10945 | LINER MATERIAL: 6061-T6 AL. ALLOY |
| SERVICE PRESSURE: 2,216 PSI (152 bar) | RESIN MATERIAL: EPOXY |
| TEST PRESSURE: 3,695 PSI (255 bar) | REINFORCEMENT MAT'L: CARBON/GLASS |
| MIN. BURST PRESSURE: 7,535 PSI (520 bar) | APPROVED GASES: AIR, OXYGEN |
| OP.TEMP.: -60°F TO +140°F (-51°C TO +60°C) | EXTERIOR SURFACES OF LINER NECK TO BE FREE OF POLYURETHANE COATING. |
| SERVICE LIFE: 15 YEARS | EXTERIOR PAINT: F. GREEN NO. 14187 PER FED-STD-595 & UV COAT |
| WATER CAPACITY: 523 CU. IN. (8.57 litre) MIN | |
| EMPTY WEIGHT: 6.7 LBS. (3.0 kg) MAX. | |

| APPROVALS | | DATE |
|-----------|---------------|----------|
| DRAWN | CUONG LE | 12-12-01 |
| CHECK | R. ALMAGRO | 12-13-01 |
| ENGRG. | R. SCHAFFER | 12-14-01 |
| MFG. | T. HOLLENBECK | 12-17-01 |
| Q.A. | R. L. BECK | 12-14-01 |

UNLESS OTHERWISE SPECIFIED DIMENSIONS ARE IN INCHES DIMENSIONS IN [] ARE IN MILLIMETERS TOLERANCE ON DECIMALS .XX± 0.03 .XXX±0.010

DO NOT SCALE DRAWING



Structural Composites Industries
A WORTHINGTON CYLINDERS COMPANY

TITLE
ENVELOPE DRAWING
WOUND PRESSURE VESSEL
SCI MODEL ALT 602

| | |
|---------------------------|---------------------------------|
| CAGE CODE 58943 | DWG. NO. 1273185 |
| SCALE: NONE | JDE #313927 SHT 1 OF 1 |